

VACUUM SUCTION PEN

Direction:

- ① Install a proper IC suction cap on the 939 suction pen.
- ② Position the suction cap in level with the IC.

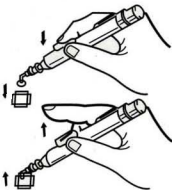

- ③ Press the button down to let out the air within the vacuum unit. Release the button to produce vacuum suction force thus picking up the IC.



- ④ Place the IC on a proper place. Press down the button until the unit discharges air out letting the IC fall off the suction cap.



- ⑤ Includes three suction caps:
 - *large size for 40g
 - *medium size for 18g
 - *small size for 3g