

part name

MOT1

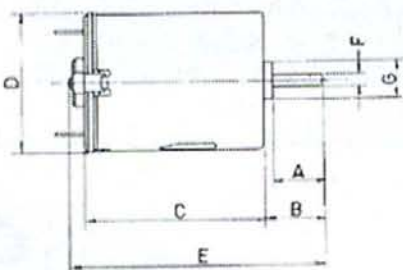
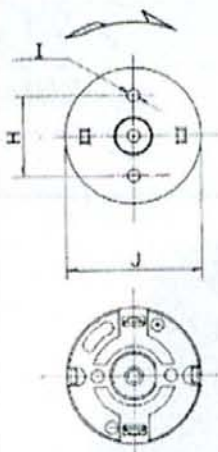
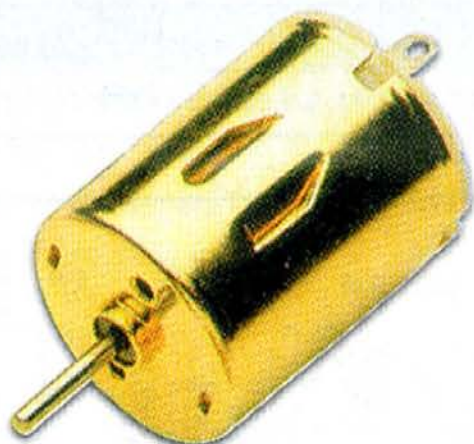

part name

MOT2

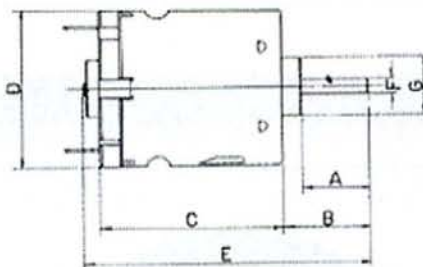
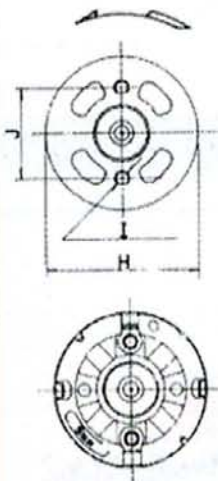

DC MOTORS

part name		MOT1	MOT2	MOT3
voltage	operating range	1.5-3V	2.4-6V	6-24V
	nominal	3V	6V	12V
no load	speed	12511rpm	13679rpm	11000rpm
	current	0.29A	0.28A	0.24A
at max. efficiency	speed	10012rpm	11404rpm	8768rpm
	current	1.16A	1.434A	0.726A
	torque	15.7gcm	45.3gcm	62.5gcm
	output	1.61W	5.312W	5.617W
	eff.	42.36%	61.74%	59.58%
stall torque		78.4gcm	277gcm	307.8gcm
dimensions	A	0.26"	0.39"	0.47"
	B	0.45"	0.45"	0.59"
	C	0.93"	1.20"	1.28"
	D	Ø0.94"	Ø0.94"	Ø1.09"
	E	1.50"	1.77"	2.01"
	F	Ø0.08"	Ø0.08"	Ø0.09"
	G	Ø0.24"	Ø0.25"	Ø0.39"
	H	Ø0.75	0.55"	Ø1.08"
	I	0.45"	Ø0.09"	M0.10" x 0.02"
	J	Ø0.09	Ø0.94"	0.63"
	K	Ø0.93		