

Roll Keyboard [Manual]

* For PS/2 connector :

- Power off the computer before installing the keyboard.
- Find out the keyboard jack on the computer rear board. You will find the remark indicating the keyboard connector as below
- Plug the round PS/2 connector into the round PS/2 port of the computer
- Turn on your computer.

Notes: Don't insert the plug force, if the plug can not comply with the jack.

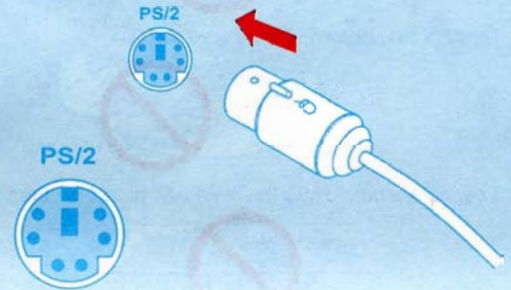

* For USB connector & USB+PS/2 converter :

- Connect the USB connector to the converter
- Power off the computer
- Plug the PS/2 connector to the computer's PS/2 interface.
- Turn on the computer then it works

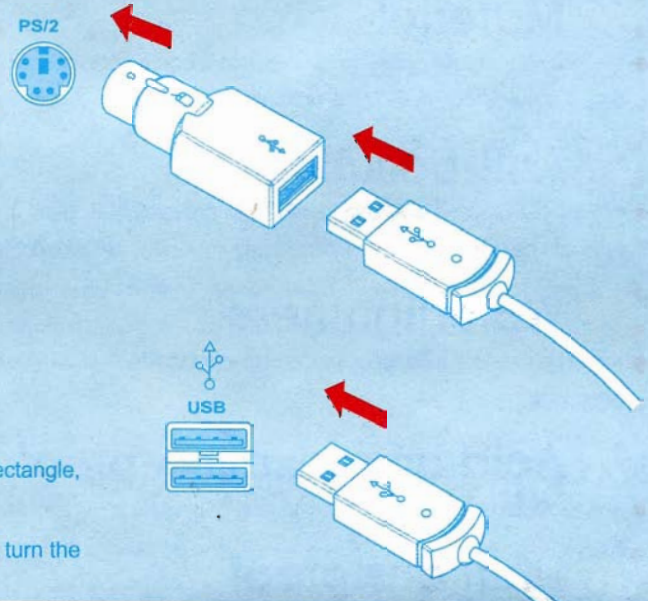

* For USB connector :

- Turn on the computer, start the computer system.
- Find out the USB jack on the front or rear of the computer. The jacks are rectangle, generally 2pcs, arranged as horizontal or vertical:
- Plug the pin of the keyboard cable into USB jack. If it is difficult to plug in, turn the pin to 180 degree. then re-plug.



The keyboard only using USB connector

Some computer system can not support USB device automatically. It may lead to some related errors or the keyboard can not work till Windows startec. Using PS/2 connector will prvent from this kind of problem if you are not sure the computer can comply with the USB keyboard or not.

Only using USB plug also can connect the keyboard, thus you can release some PS/2 related system resource. In order to achieve it, you need the BIOS system to support USB keyboard, which will control the communication between computer and its device.

If you want to check whether your system support USB device, please infer to your computer related file or contact the computer manufacturer. Some computer manufacturers provide BIOS updating in the internet so that they can make your system support USB keyboard.

The usage norm of the Roll-keyboard ↓

The Roll-keyboard can be used in below conditions:

- It must be used on an even working face.



- It can be used in the damp environment even shallow water.



- It can be used in the acidity and alkaline environment.



- It can be used in the temperature of -40°C - $+80^{\circ}\text{C}$.



- It can be used in the dusty environment even sandstorm.



- It can be laundered by alcohol or disinfectant.

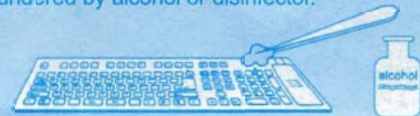

The Roll-keyboard cannot be used in below conditions.

- It cannot be contacted the sharp object.
- It cannot be contacted the oil or the organic impregnate like acetone and toluol etc.



- It cannot be pressed when it was rolled.



- Cannot places the heavy object on it in long time.



- It cannot be putted into the oven and putted on the fire to roast.



- We cannot put out strength to twist or pull it.



* Material

- Made by high-quality silicone, the keyboard has no poisonous and evil smell, according to the requirement of the environmental protection, it is a kind of creative new product.

* Anti-pollution

- In view of the fact it is all seal completely, preventing all kinds of germs and pollutants exting into the keyboard, and the keyboard's surface can be washed and disinfected any time, so it can prevent the disease infection.

* Watertightness

- It can be used for a damp environment, even inside shallow water. It can be normally used when beverage or other liquids spilled at the keyboard.

* Acid and alkaline-proof

- The keyboard can be used safely in acid or alkaline environment.

* High dustproof

- The keyboard can be used safely in dust fog and even in sandstorm.

* Carrying convenience

- Because the keyboard can be rolled up, so it can save lots of spaces while carrying.

* Other characteristics

- The special printing technology guarantees the letter on the buttons of keyboard not to be worn away for a long time.
- Feeling soft comfortable.
- Soft without any sound while typing.
- Various beautiful colors; The button bears to type 2 million times.
- The keyboard is applicable to office; hospital Classroom; workshop; network bar; laboratory; kid room; notebook PC; army; etc.

* SPECIFICATION

- | | |
|--|--|
| ● Compatibility : IBM Windows98/2000/Me/XP | ● Compatibility : IBM Windows98/2000/Me/XP |
| ● Commvnication : USB, PS/2, USB+PS/2 | ● Commvnication : USB, USB+PS/2 |
| ● Layout: 109keys | ● Layout : 85keys |
| ● Dimension(mm) : 495(L)X138(W)X12(H) | ● Dimension(mm) : 350(L)X135(W)X12(H) |
| ● Electronic data : +5V DC \pm % @ 250mA | ● Electronic data : +5V DC \pm % @ 250mA |
| ● Tatal travel: 2mm \pm 4 | ● Tatal travel: 2mm \pm 4 |
| ● Weight(kg) : 0.20 | ● Weight(kg) : 0.18 |

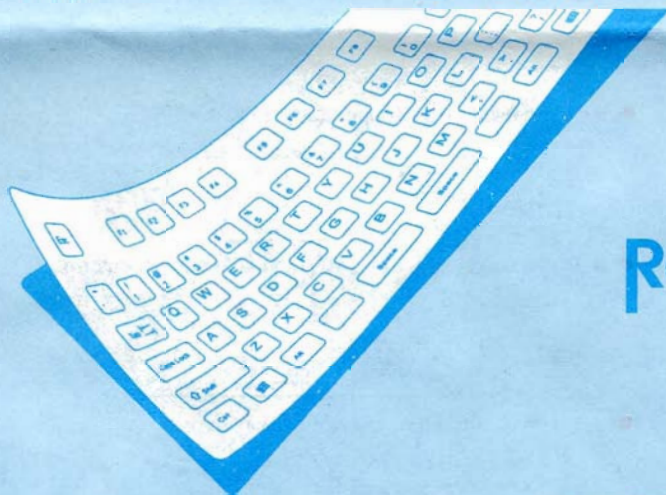

Roll Keyboard [Manual] *

